

Appendix 6
Year One and Two Garage Refurbishment Works

Summary of works

Programme Year	Estate Name	Total	Void	Void %	Income Shortfall	Estimated Cost	Lighting Costs	FOB Access Costs	Recovery Years (excluding lighting and FOB access)	Recovery Years Total
2016/2017	Thackery Court	20	10	50%	£12,002	£19,518	£0	£0	2.2	2.2
2016/2017	Sulgrave Gardens	13	5	38%	£6,001	£23,583	£0	£0	5.7	5.7
2016/2017	Flora Gardens Estate	13	6	46%	£8,401	£7,607	£0	£0	0.9	0.9
2016/2017	Forbisher Court	20	12	60%	£14,408	£26,240	£0	£0	1.8	1.8
Year 2016/2017	4 Sites	66	33	49%	£40,812	£76,948	£0	£0	2.6	2.6
2017/2018	Derwent Court	17	5	29%	£6,000	£17,703	£0	£0	3	3.0
2017/2018	Woodmans Mews	20	7	35%	£8,401	£7,438	£3,785	£0	0.9	1.3
2017/2018	Charecroft Estate	122	42	34%	£50,428	£110,350	£28,350	£0	2	2.8
2017/2018	Edward Woods Estate	116	61	53%	£73,241	£191,858	£0	£0	2.6	2.6
2017/2018	Linacre Court	26	12	46%	£14,402	23,415	£0	£0	1.5	1.5
2017/2018	Wood Lane Estate	63	38	60%	£45,606	£65,614	£2,665	£42,000	1.4	2.4
Year 2017/2018	6 Sites	364	165	43%	£198,078	£416,378	£34,800	£42,000	1.9	2.3
Sub Total	10 Sites	430	198		£238,890		£588,182		2.2	2.4

Appendix 6
Year One and Two Garage Refurbishment Works

Thackeray Court, Blythe Road, London, W14 0PW



- //// mesh partition
- brick wall partition
- doors

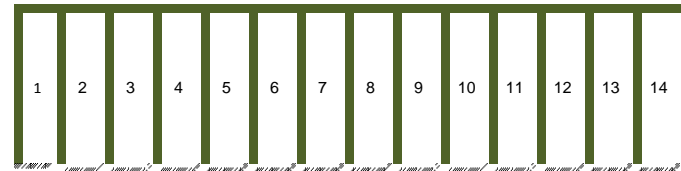
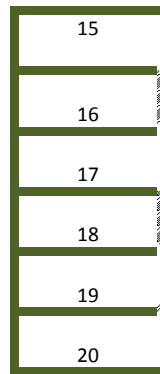

Appendix 6
Year One and Two Garage Refurbishment Works

Sulgrave Gardens, London, W6 7RA



- mesh partition
- brick wall partition
- doors

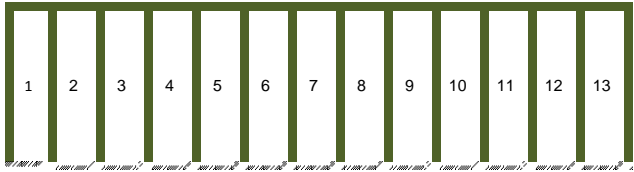

Appendix 6
Year One and Two Garage Refurbishment Works

Flora Gardens, London, W6 0HR



Appendix 6
Year One and Two Garage Refurbishment Works

Woodmans Mews, London, W12 0HU

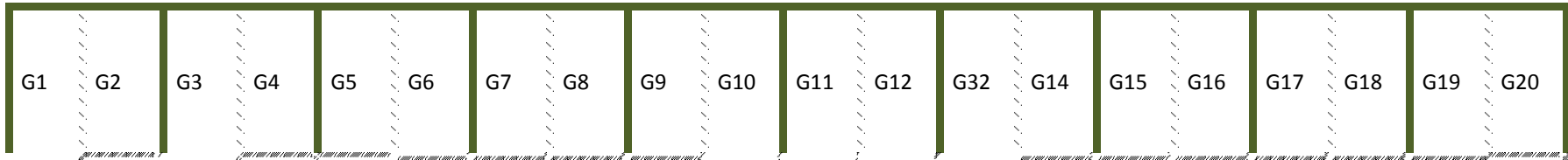
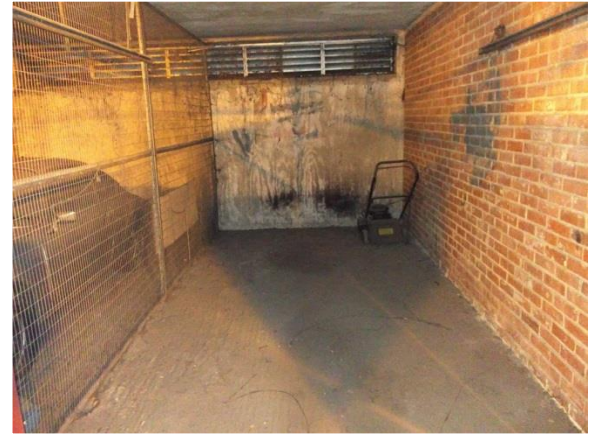

////// mesh partition

———— brick wall partition

▭ doors

Appendix 6
 Year One and Two Garage Refurbishment Works
 Derwent Court, 1 Ravenscourt Park, London, W6 0TT

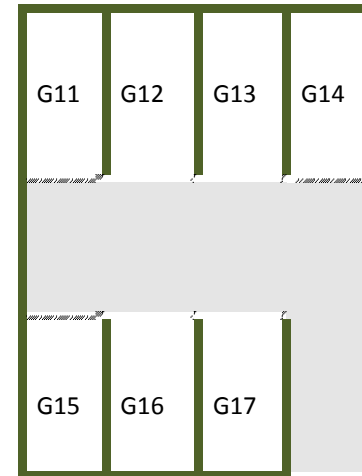

- //// mesh partition
- brick wall partition
- doors

Appendix 6
Year One and Two Garage Refurbishment Works
Frobisher Court, 60 Lime Grove, London, W12 8ED



mesh partition

brick wall partition

doors

Appendix 6
Year One and Two Garage Refurbishment Works

Charecroft Estate, Woodford Court, 33 Shepherd's Bush Green, London, W12 8QY

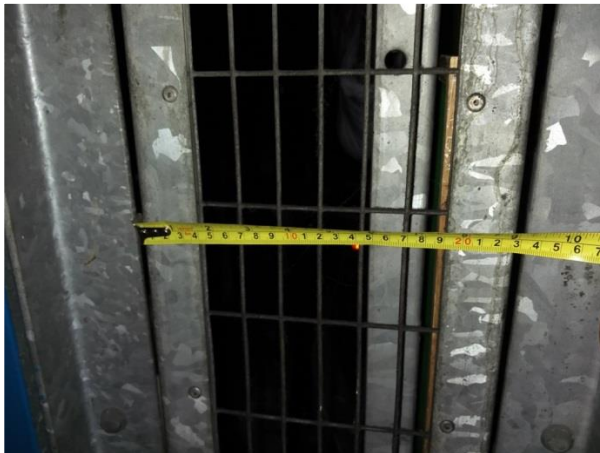

Appendix 6 Year One and Two Garage Refurbishment Works

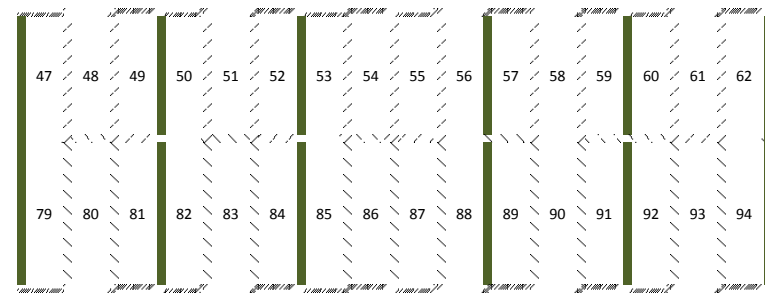
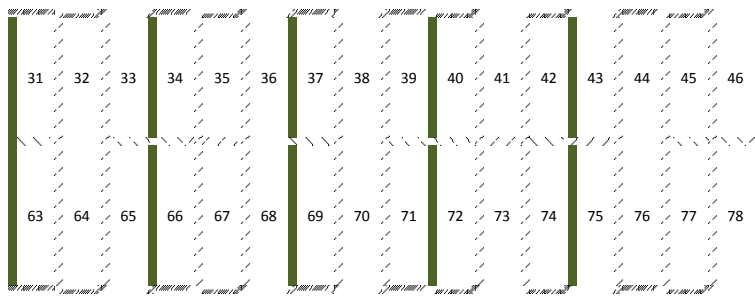
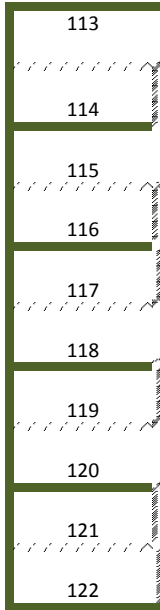
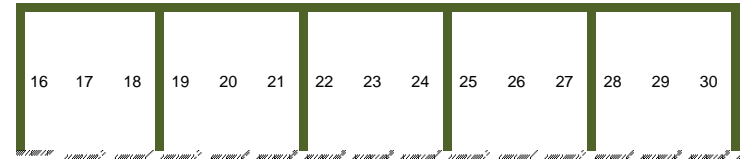
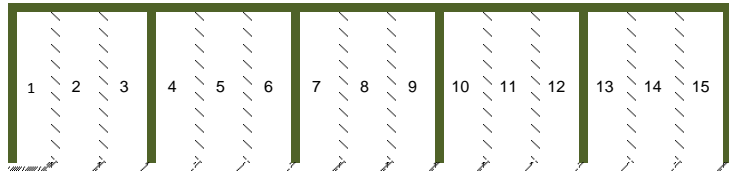

..... mesh partition

———— brick wall partition

..... doors

Appendix 6
Year One and Two Garage Refurbishment Works

Edward Woods Estate, Queensdale Crescent, London, W11 4TP



Appendix 6
Year One and Two Garage Refurbishment Works

Hume House

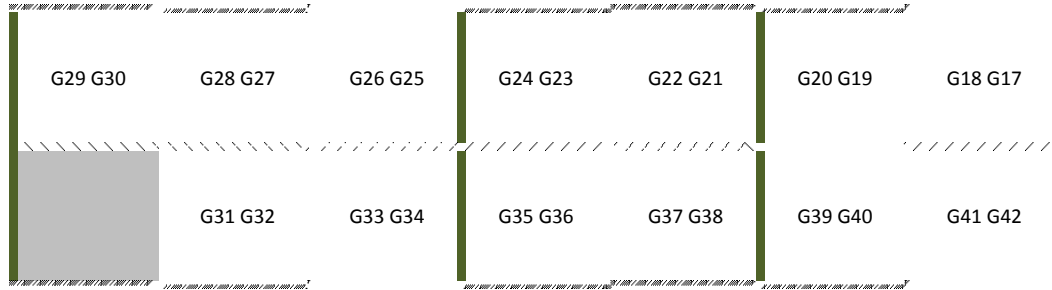

..... mesh partition

———— brick wall partition

..... doors

Appendix 6
Year One and Two Garage Refurbishment Works

Boxnoor House

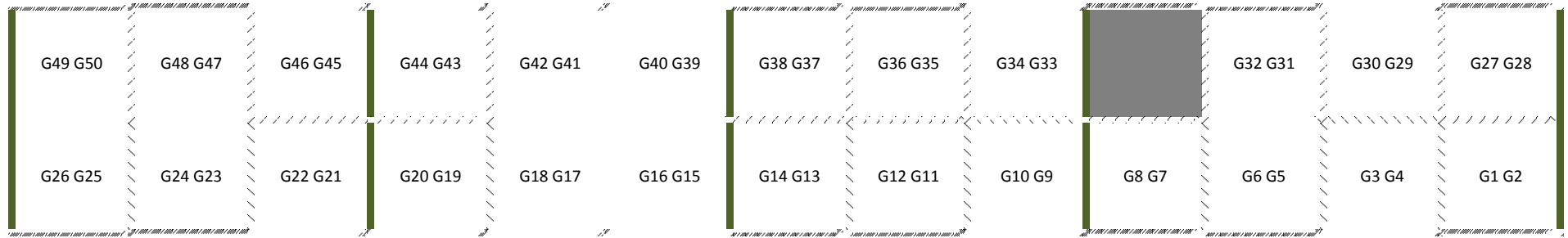

..... mesh partition

———— brick wall partition

▭ doors

Appendix 6
Year One and Two Garage Refurbishment Works

Mortimer House

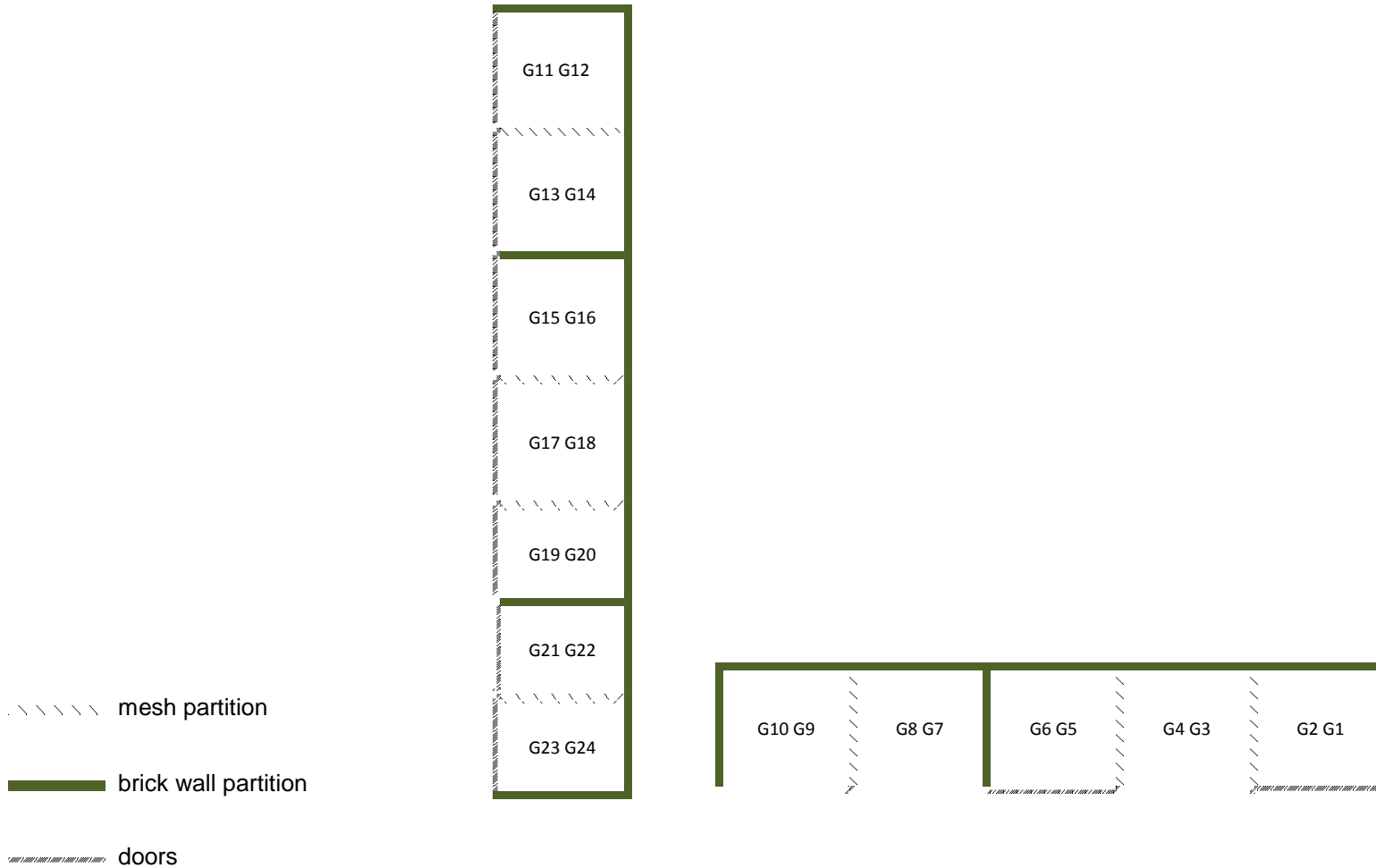

Appendix 6
Year One and Two Garage Refurbishment Works

Wood Lane Estate, London, W12 7EE

Exhibition Close



\\\\\\\\\\\\ mesh partition

— brick wall partition

— doors

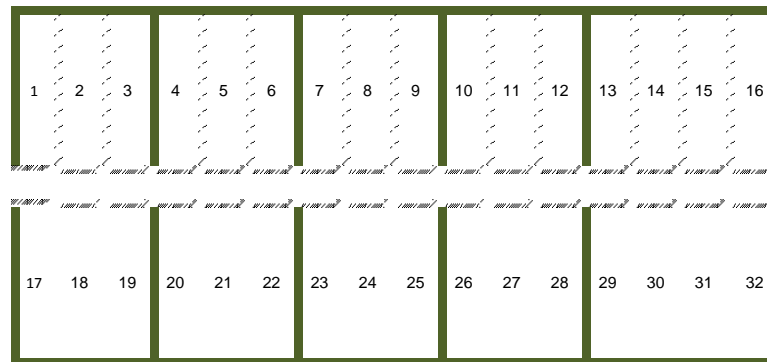

Appendix 6
 Year One and Two Garage Refurbishment Works

White City Close

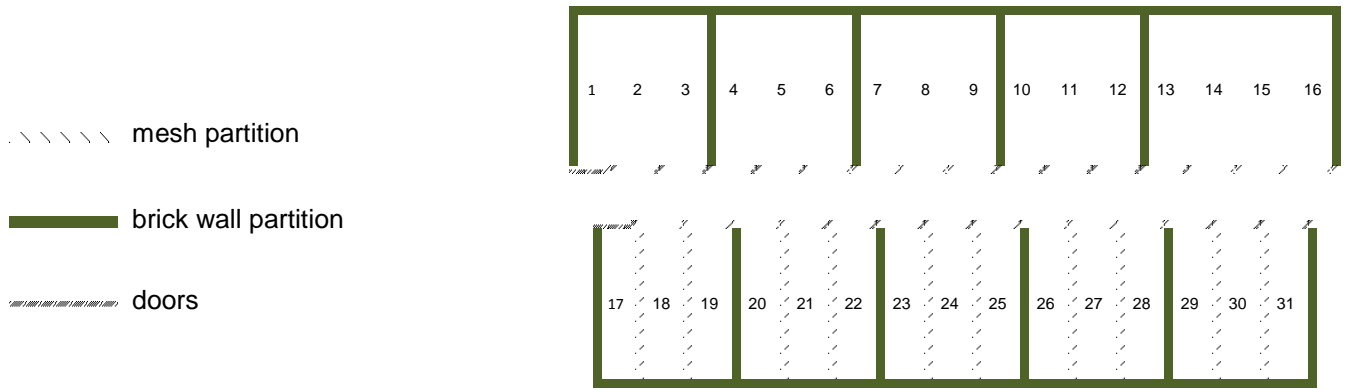

Appendix 6
 Year One and Two Garage Refurbishment Works
 Linacre Court, Great Church Lane, London, W6 8DE

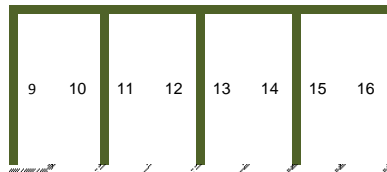

..... mesh partition

———— brick wall partition

===== doors

